

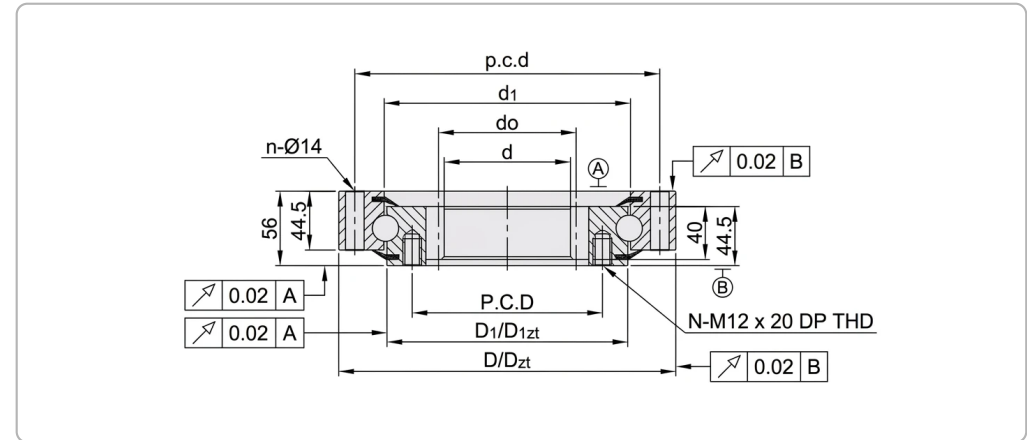

Product View



Section Drawing

**Technical Parameters**

Parameter	Value
Contact Type	4-Point Contact
Gear Type	Internal Gear Type
Precision Class	P5
Sealing	Rubber seals on both sides
Material	SUJ2 (GCr15)
Operating temperature	-20°C to +80°C
Running Accuracy	Radial & Axial Run-out <= 0.02 mm
Raceway Hardness	58-62 HRC
Bore Diameter (d)	444 mm
Height (H)	56 mm
Outside Diameter (D)	616 mm
Outside diameter tolerance	-0.5mm to 0
Width outer ring (ha)	44.5 mm
Width inner ring (hi)	44.5 mm
Width gearing (b)	40 mm
Outer Ring Pilot Diameter (Dzt)	614 mm
Inner diameter outer ring (d1)	545.5 mm
Inner diameter outer ring tolerance	0.5mm to 0
Outside diameter inner ring (D1)	542.5 mm

Parameter	Value
Outside diameter inner ring tolerance	-0.5mm to 0
Inner Ring Pilot (D1zt)	541 mm
Pitch circle diameter gearing (do)	456 mm
Module of gearing (M)	6 mm
Number of teeth (Z)	76
Pressure Angle	20°
Pitchcircle diameter fixing holes outer ring (p.c.d)	590 mm
Number of fixing holes in outer ring (n)	32
Fixing bore	14 mm
Pitchcircle diameter fixing holes inner ring (P.C.D)	505 mm
Number of fixing holes in inner ring (n)	32
Threaded fixing bore	M12
Thread depth fixing hole	20 mm
Basic dynamic load rating, axial (Ca)	188 KN
Basic static load rating, axial (C0a)	740 KN
Basic dynamic load rating, radial (Cr)	123 KN
Basic static load rating, radial (C0r)	325 KN
Radial Clearance	0-0.05 mm
Axial Clearance	0-0.08 mm